

THIRD FLOOR LIFE SAFETY PLAN

SCALE: 1/16" = 1'-0"

BUILDING CODE INFORMATION

THE DRAWINGS HAVE BEEN PREPARED IN ACCORDANCE WITH THE FOLLOWING CODES, NOTIFY THE ARCHITECT OF ANY CONFLICTS

CODES

2012 NFPA 101 LIFE SAFETY CODE
2015 MICHIGAN REHABILITATION CODE (AS AMENDED) - Chapters 7 & 8
2015 MICHIGAN MECHANICAL CODE (AS AMENDED)
2015 MICHIGAN PLUMBING CODE (AS AMENDED)
2017 NATIONAL ELECTRIC CODE (NEC) (AS AMENDED - MICHIGAN AMENDMENTS PART 8 RULES)
2015 MICHIGAN ENERGY CODE
INTERNATIONAL ENERGY CONSERVATION CODE - 2009, SECTION 501.1
ANSI/ASHRAE/IESNA STANDARD 90.1-2007 (AS AMENDED)
2015 INTERNATIONAL FIRE CODE
BARRIER FREE REQUIREMENTS:
AMERICANS WITH DISABILITIES ACT (ADA)
MBC-2015, CHAPTER 11
ICC A117.1-2009, EXCEPT SECTIONS 611 & 707

ITEM

CODE SECTION

CLASSIFICATION OF WORK

(INCL. AMENDMENTS)

CLASSIFICATION TYPE

(MRC-CHAPTER 5)

LEVEL 2 ALTERATIONS INCLUDE THE RECONFIGURATION OF SPACE, THE ADDITION OR ELIMINATION OF ANY DOOR OR WINDOW, THE RECONFIGURATION OR EXTENSION OF ANY SYSTEM, OR THE INSTALLATION OF ANY ADDITIONAL EQUIPMENT.

BUILDING USE GROUP

(MBC-SEC. 304)

MIXED USE NON-SEPARATED: B - BUSINESS / A-3 - ASSEMBLY

TYPE OF CONSTRUCTION

CONSTRUCTION TYPE: I(A) (ASSUMED) NON-SPRINKLERED (MBC-SEC. 602)
TYPE II (III) (ASSUMED) NON-SPRINKLERED (NFPA: 7.2.1.1)

FIRE RESISTANCE RATINGS OF STRUCTURAL ELEMENTS

ITEM	RATING (HOURS)	UL NO.	REMARKS
STRUCTURAL FRAME	1	EXISTING	(TABLE 601)
BEARING WALLS - EXT.	1	EXISTING	(TABLE 601)
INT.	1	EXISTING	(TABLE 601)
NONBEARING WALLS - EXT.	0	EXISTING	(TABLE 601)
INT.	0	EXISTING	(TABLE 601)
FLOOR CONSTRUCTION	1	EXISTING	(TABLE 601)
ROOF CONSTRUCTION	1	EXISTING	(TABLE 601)
SHAFT ENCLOSURES	2	EXISTING	(SEC. 713.4)
STAIR ENCLOSURES	1	EXISTING	(SEC. 1023.2)
CORRIDOR WALLS IN AREA OF RENOVATION	1	U419	(NFPA 8.3.3.11)

OCCUPANCY

OCCUPANT LOAD:

2012 NFPA 101 LIFE SAFETY CODE, TABLE 7.3.1.2
2015 MICHIGAN BUILDING CODE, TABLE 1004.1.2

ASSEMBLY UNCONCENTRATED (TABLES AND CHAIRS) 1 / 15 NET (IN AREA OF RENOVATION)

CURRENT BUILDING OCCUPANCY (ASSUMED):

GROUND FLOOR: 208 OCC
FIRST FLOOR: 208 OCC
SECOND FLOOR: 208 OCC
THIRD FLOOR: 208 OCC
TOTAL: 835 OCC

OCCUPANTS ADDED BY RENOVATION:

GROUND FLOOR: 0 OCC
FIRST FLOOR: 0 OCC
SECOND FLOOR: 0 OCC
THIRD FLOOR: 63 OCC
TOTAL: 63 OCC

PROPOSED BUILDING OCCUPANCY INCLUDING REOVATION:

GROUND FLOOR: 208 OCC
FIRST FLOOR: 208 OCC
SECOND FLOOR: 208 OCC
THIRD FLOOR: 272 OCC
TOTAL: 896 OCC

THE PROPOSED BUILDING OCCUPANCY HAS INCREASED BY 7.5%

PLUMBING FIXTURE REQUIREMENTS:

PER THE MICHIGAN REHABILITATION CODE FOR EXISTING BUILDINGS, SECTION 810 MINIMUM FIXTURES, WHERE THE OCCUPANT LOAD OF THE STORY IS INCREASED BY MORE THAN 20 PERCENT, PLUMBING FIXTURES FOR THE STORY SHALL BE PROVIDED IN QUANTITIES SPECIFIED IN THE *INTERNATIONAL PLUMBING CODE* BASED ON INCREASED OCCUPANT LOAD.

PROJECT COMPLIES: NO MODIFICATIONS TO THE PLUMBING FIXTURE COUNT IS REQUIRED.

MEANS OF EGRESS IN WORK AREAS:

A MINIMUM OF TWO MEANS OF EGRESS ARE PROVIDED FROM ALL RENOVATION AREAS.

COMMON PATH OF TRAVEL: 75' WITHOUT SPRINKLERS (TABLE 1006.2.1)
PROJECT COMPLIES (MBC) (NFPA)

EXIT ACCESS TRAVEL DISTANCE: 200' WITHOUT SPRINKLERS (TABLE 1017.2)
PROJECT COMPLIES

EGRESS COMPONENTS WITHIN THE WORK AREA (TABLE 1005.3)

OCCUPANCY 80 STAIRWAYS 0.3" OTHER COMPONENTS 0.2"

AREA OF RENOVATION: 80 PEOPLE x 0.2"/PERSON = 16 INCHES
PROVIDED: 2 DOORS @ 33 INCHES CLEAR = 66 INCHES

THIRD FLOOR: 272 PEOPLE x 0.2"/PERSON = 54.4 INCHES
PROVIDED: 10 DOORS @ 33 INCHES CLEAR = 330 INCHES

FIRST THRU THIRD FLOOR: 690 PEOPLE x 0.3"/PERSON = 207 INCHES (44 MIN.)
PROVIDED: 2 STAIR @ 82 INCHES CLEAR = 164 INCHES

1 STAIR @ 44 INCHES CLEAR = 44 INCHES

TOTAL: 208 INCHES - PROJECT COMPLIES

LIFE SAFTEY KEY

- 1-HOUR WALL
- 2-HOUR WALL
- OCCUPANT COUNT
- TRAVEL DISTANCE

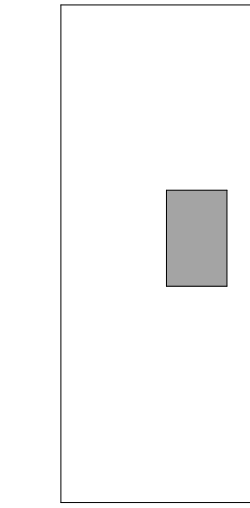

KEY PLAN



WAYNE STATE UNIVERSITY

ftc&h

engineers
scientists
architects
constructors

fishbeck, thompson, carr & huber, inc.
www.ftch.com

Wayne State University

5557 Cass Ave, Detroit, MI 48202

Cohn Building Student Commons

WSU PROJECT NUMBER: 048-291367

REVISIONS

10/31/2019 Permits and Bids

Drawn By JP

Designer YF/CT

Reviewer WTB

Manager VJM

Hard copy is intended to be 24"x36" when plotted. Scale(s) indicated and graphic quality may not be accurate for any other size.

PROJECT NO.

190812

LIFE SAFETY PLANS

LS101

©Copyright 2019
All Rights Reserved

PLOT INFO: 10/31/2019 8:54:10 AM C:\Work\Revit\2019_A_190812_lapman.rvt

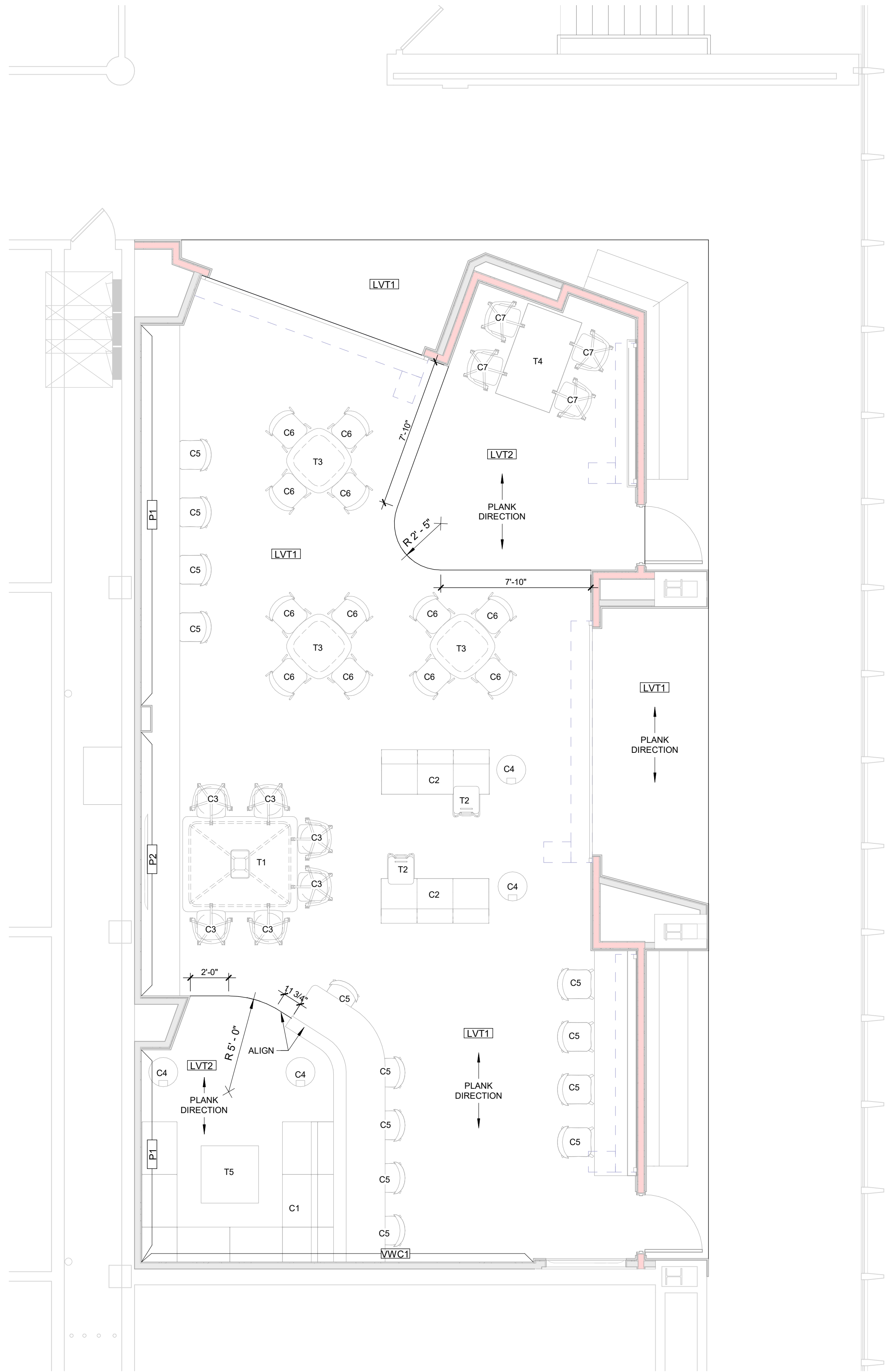

THIRD FLOOR FINISH PLAN

SCALE: 1/4" = 1'-0"

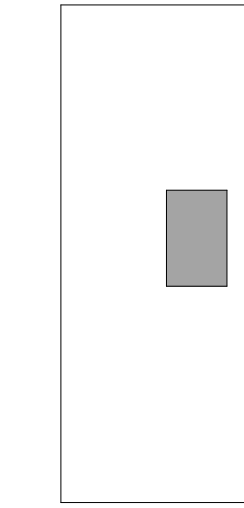

KEY PLAN

NOTES

- ALL WALLS TO BE FACED WITH PLASTIC LAMINATE (PL1) UNLESS NOTED OTHERWISE.



WAYNE STATE
UNIVERSITY

ftc&h

engineers
scientists
architects
constructors

fishbeck, thompson, carr & huber, inc.
www.ftch.com

Wayne State University

5557 Cass Ave, Detroit, MI 48202

Cohn Building Student Commons

WSU PROJECT NUMBER: 048-291367

REVISIONS

10/31/2019 Permits and Bids
Drawn By CT
Designer YF/CT
Reviewer WTB
Manager VJM

Hard copy is intended to be
24"x36" when plotted. Scale(s)
indicated and graphic quality may
not be accurate for any other size.

PROJECT NO.
190812





FLOOR FINISH PLANS

A701

© Copyright 2019
All Rights Reserved

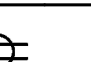
PLOT INFO: 10/31/2019 11:47:08 AM C:\Work\Revit\2019_E_190812_JM5.rvt

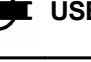
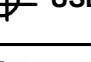
WIRING DEVICES - MANUAL POWER SWITCH SCHEDULE				
SYMBOL	DESCRIPTION	MANUFACTURER	CATALOG NO.	REMARKS
S K	KEYED MANUAL SWITCH	PROVIDED BY FIRE SHUTTER MANUFACTURER		

WIRING DEVICES - RECEPTACLE SCHEDULE				
SYMBOL	DESCRIPTION	MANUFACTURER	CATALOG NO.	REMARKS
	DUPLEX RECEPTACLE	HUBBELL	HBL5362I	MOUNT 18" AFF, UNO
	DUPLEX RECEPTACLE (ABOVE COUNTER)	HUBBELL	HBL5362I	MOUNT HORIZONTALLY ABOVE COUNTER; 2-INCHES ABOVE BACKSPLASH, UNO
	DUPLEX RECEPTACLE WITH TWO USB CHARGING PORTS	HUBBELL	USB8300I	MOUNT 18" AFF, UNO
	DUPLEX RECEPTACLE WITH TWO USB CHARGING PORTS (ABOVE COUNTER)	HUBBELL	USB8300I	MOUNT HORIZONTALLY ABOVE COUNTER; 2-INCHES ABOVE BACKSPLASH, UNO
	DOUBLE DUPLEX RECEPTACLE WITH FOUR USB CHARGING PORTS	HUBBELL	(2) USB8300I	MOUNT AT 18" AFF, UNO
	2-GANG RECESSED WALL BOX FOR VIDEO MONITOR POWER AND DATA WITH DUPLEX RECEPTACLE	LEGRAND WIREMOLD	EFSB2	MOUNT AT 18" AFF, UNO; PROVIDE (1) HUBBELL #HBL5362I DUPLEX RECEPTACLE

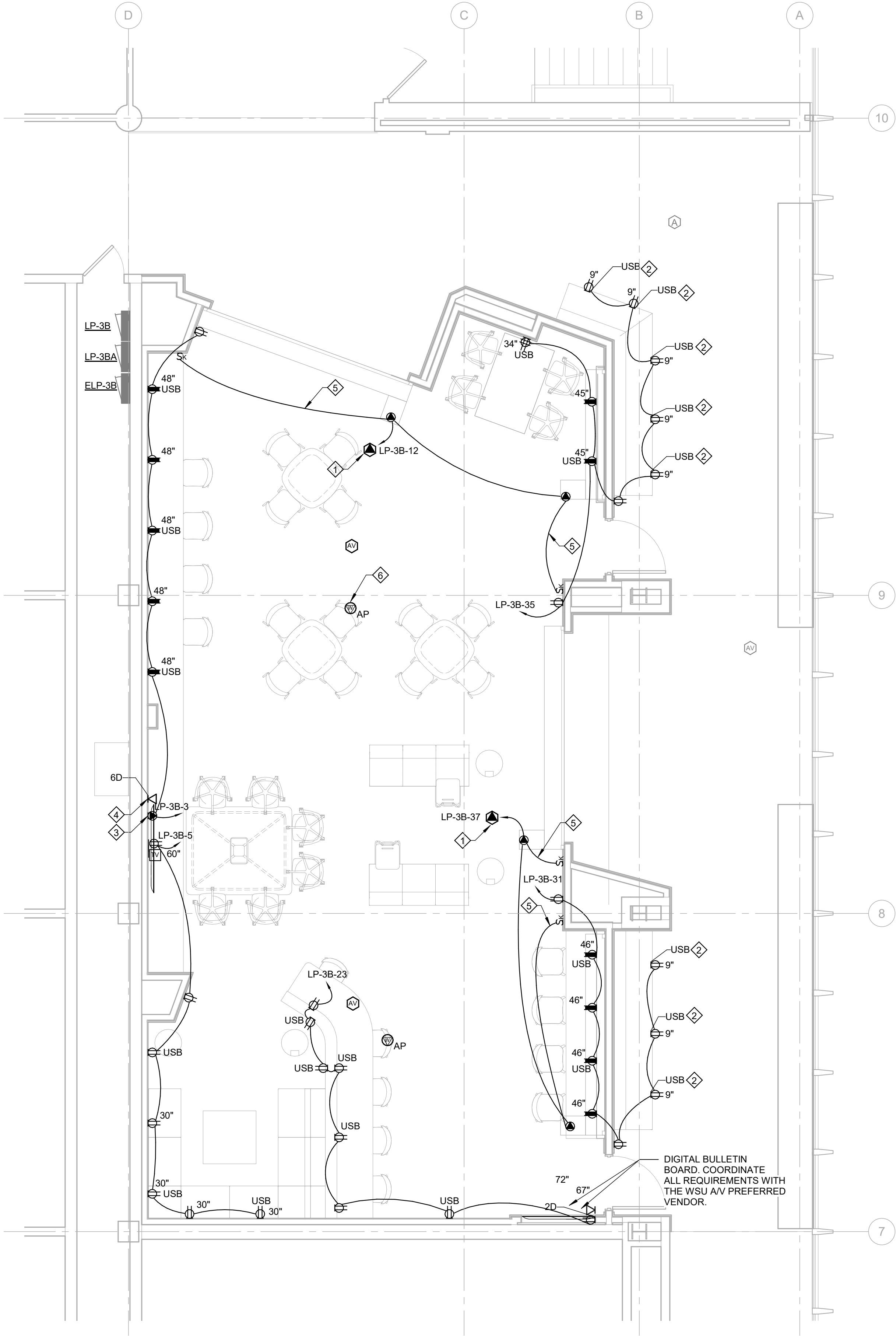

THIRD FLOOR POWER AND SYSTEMS PLAN
SCALE: 1/4" = 1'-0"

NOTES

- REFER TO DRAWING E001 FOR THE ELECTRICAL GENERAL NOTES AND REQUIREMENTS.
- CIRCUIT NUMBERS ARE SHOWN FOR GROUPING PURPOSES ONLY. UTILIZE CIRCUITS MADE AVAILABLE THROUGH DEMOLITION OR SPARE CIRCUIT BREAKERS. ALL BRANCH CIRCUIT WIRING SHALL BE NEW.
- PROVIDE WIRING DEVICE COVERPLATE SAMPLES FOR REVIEW DURING THE SHOP DRAWING SUBMITTAL PROCESS.
- ALL DATA CABLING AND ASSOCIATED RACEWAYS SHALL BE INSTALLED PER WAYNE STATE STANDARDS FOR COMMUNICATIONS INFRASTRUCTURE - 29 JULY 2019.

KEY NOTES

- FIRE ALARM CONTROL MODULE TO RELEASE FIRE SHUTTERS UPON FIRE ALARM ACTIVATION.
- MOUNT HORIZONTALLY IN THE VERTICAL PORTION OF THE BENCH.
- POWER FEED FOR FURNITURE "D" TABLE. REFER TO THE CONNECTRAC DETAIL ON E501.
- LOW VOLTAGE FEED FOR FURNITURE "D" TABLE. REFER TO THE CONNECTRAC DETAIL ON E501.
- 4#12, #12 GRD, 3/4"C.
- RELOCATED WIRELESS ACCESS POINT.

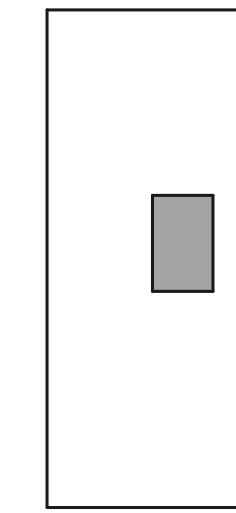

KEY PLAN
NORTH

REVISIONS

10/31/2019	Permits and Bids
Drawn By CJM	
Designer JAM	
Reviewer RMM	
Manager VJM	

Hard copy is intended to be 24"x36" when plotted. Scale(s) indicated and graphic quality may not be accurate for any other size.

PROJECT NO.
190812
THIRD FLOOR POWER AND SYSTEMS PLAN

E201
©Copyright 2019
All Rights Reserved