

REMOVE EXISTING
DOOR AND ADD GYP.
BD PARTITION

NEW DOOR AND
HARDWARE
(SEE DOOR SCHED.)

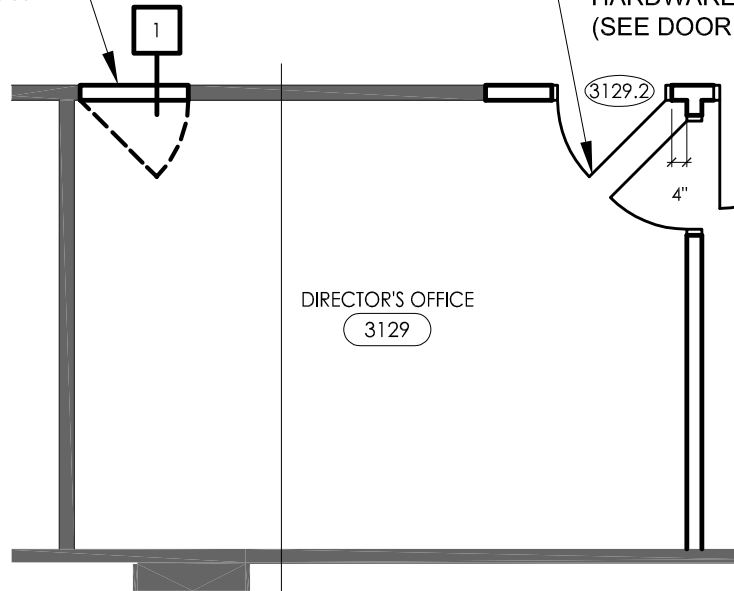

4
A-200

ALTERNATE 4 FLOOR PLAN DIRECTOR'S OFFICE 3129

3/16" = 1'-0"

ALTERNATE BID NOTE

4. ALTERNATE 4 - REMOVE EXISTING DOOR AND ADD
NEW DOOR IN DIRECTOR'S OFFICE 3129
- REMOVE EXISTING DOOR, PATCH WALL TO MATCH
EXISTING AND ADD NEW DOOR AND HARDWARE.

DOOR SCHEDULE

| DOOR NO. | DOOR SIZE | DOOR | | | FRAME | | | | | H.W. NO. | MIN./ LABEL | REMARKS |
|-------------|---------------|------|------|------|-------|------|------|--------|--------|-------------|----------------|---|
| | | TYPE | MAT. | FIN. | TYPE | MAT. | FIN. | JAMB | HEAD | | | |
| 3129 | 3'-0" x 7'-0" | A | WD | WD | 1 | HM | PTD | 1/A700 | 1/A700 | 1 | - | REUSE DOOR AND HARDWARE FROM RM 3303 |
| 3129.1 | 3'-0" x 7'-0" | A | WD | WD | 2 | HM | PTD | 1/A700 | 1/A700 | 1 | - | REUSE DOOR AND HARDWARE FROM RM 3305 |
| 3129.2 | 3'-0" x 7'-0" | A | WD | WD | 1 | HM | PTD | 1/A700 | 1/A700 | 4 | - | ALTERNATE 4 |
| 3135 | 3'-0" x 7'-0" | A | WD | WD | 1 | WD | PTD | | 2/A700 | 2 | - | REUSE DOOR AND |

HARDWARE SET #4

- (1) 3 (EA) HINGE 5BB1 4.5 X 4.5 652 IVE
(2) 1 (EA) OFFICE LOCK ML2051 LSM 626 C-R
(3) 1 (EA) WALL STOP WS33 626 IVE



iDesign Solutions, LLC
200 Water Street, LL1
Rochester, MI 48307

Scientific Facilities and
Laboratory Design
248-440-7310
info@iDesign-Solutions.info
www.iDesign-Solutions.info

SCOTT HALL THIRD FLOOR RENOVATION

Wayne State University
Detroit, MI

ADDENDUM #2

| | |
|---------------------------|------------------|
| Project No. 612-221763 | SKA - 100 -1 |
| Date 02/4/13 | |
| Drawn By RO | Checked By LC |
| Scale 3/16" = 1'-0" | |

DOOR SCHEDULE

| DOOR NO. | DOOR SIZE | DOOR | | | FRAME | | | | | H.W. NO. | MIN./ LABEL | REMARKS |
|----------|---------------|------|------|------|-------|------|------|--------|--------|----------|-------------|--|
| | | TYPE | MAT. | FIN. | TYPE | MAT. | FIN. | JAMB | HEAD | | | |
| 3129 | 3'-0" x 7'-0" | A | WD | WD | 1 | HM | PTD | 1/A700 | 1/A700 | 1 | - | REUSE DOOR AND HARDWARE FROM RM 3303 |
| 3129.1 | 3'-0" x 7'-0" | A | WD | WD | 2 | HM | PTD | 1/A700 | 1/A700 | 1 | - | REUSE DOOR AND HARDWARE FROM RM 3305 |
| 3129.2 | 3'-0" x 7'-0" | A | WD | WD | 1 | HM | PTD | 1/A700 | 1/A700 | 4 | - | ALTERNATE 4 |
| 3135 | 3'-0" x 7'-0" | A | WD | WD | 1 | WD | PTD | | 2/A700 | 2 | - | REUSE POCKET DOOR AND HARDWARE FROM RM 3325 |
| 3137 | 3'-0" x 7'-0" | A | WD | WD | 1 | HM | PTD | 1/A700 | 1/A700 | 1 | - | REUSE DOOR AND HARDWARE FROM RM 3137 |
| 3305 | 3'-0" x 7'-0" | C | GL | PREF | | | | | | 3 | - | NEW FRAMELESS GLASS PIVOT DOOR |
| 3307 | 3'-0" x 7'-0" | A | WD | WD | 1 | HM | PTD | 1/A700 | 1/A700 | 1 | - | REUSE DOOR FROM RM 3307 LOCKSET FROM RM 3325 |
| 3325 | 3'-0" x 7'-0" | A | WD | WD | 1 | HM | PTD | 1/A700 | 1/A700 | 1 | - | REUSE DOOR FROM 3325 LOCKSET FROM RM 3307 |
| 3329.2 | 3'-0" x 7'-0" | A | WD | WD | 1 | WD | PTD | | | 2 | - | REUSE POCKET DOOR AND HARDWARE FROM RM 3327 |
| | | | | | | | | | | | | |

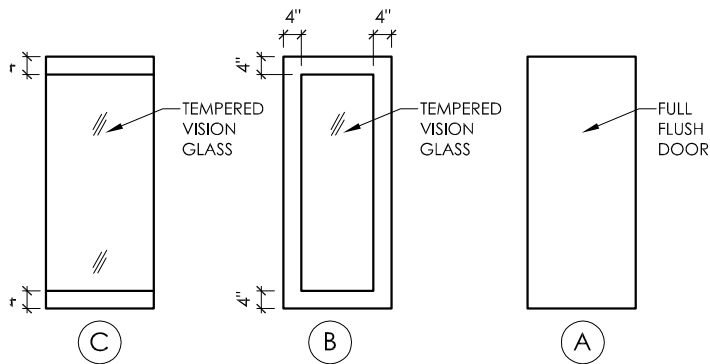

DOOR TYPES

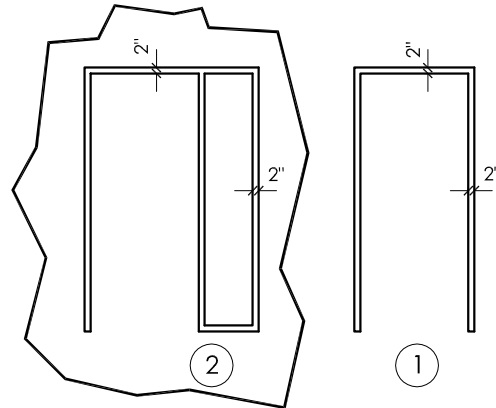

FRAME TYPES

SEAL FRAME PERIMETER WITH SILICONIZED ACRYLIC SEALANT, TYPICAL.

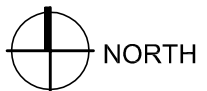

iDesign Solutions, LLC
200 Water Street, LL1
Rochester, MI 48307

Scientific Facilities and
Laboratory Design
248-440-7310
info@iDesign-Solutions.info
www.iDesign-Solutions.info

SCOTT HALL THIRD FLOOR RENOVATION

Wayne State University
Detroit, MI

ADDENDUM #2

| | | |
|---------------------------|------------------|------------------------|
| Project No. 612-221763 | SKA - 100 -2 | |
| Date 02/4/13 | | |
| Drawn By RO | Checked By LC | Scale 3/16" = 1'-0" |



FINELITE

Series 5 - Technical Sheet

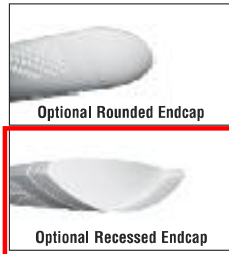

Date

Project

Type **FA/FAE**

Comments

DESCRIPTION

The Series 5 is a slim, curving 2.4" by 9.5", low-profile lighting fixture with optical performance and mechanical fit. The softly radiant downlight portion is achieved by a precision punched 0.062" diameter perforation pattern over most of the fixture surface.

Perf or Indirect - T8 / T5HO

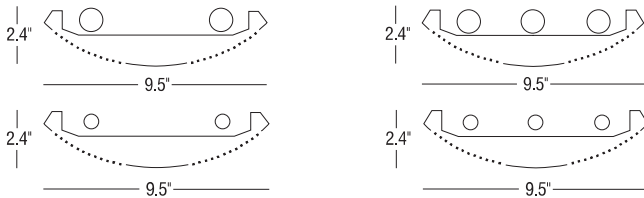

DIMENSIONS / LAMPING:

Available in 2 or 4 T8 lamp cross sections.

**PROVIDE EMERGENCY BATTERY BALLAST
FOR FIXTURES DESIGNATED WITH AN "E" SUFFIX**

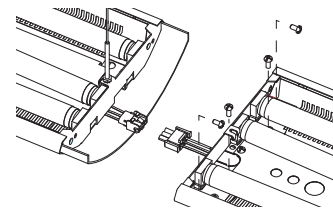

PRECISION JOINING:

Series 5's new 14-gauge die-formed steel joining aligner (tolerance 0.010") slides easily into the fixture and fits securely against the welded end bracket. Electrical wiring is easy with quick connect plugs.

ORDERING GUIDE

Sample Number: S5-P - 32' - 2T8 - SC - 91W - 277 - AC 18" - FE - C1 - 0.88

| | | | | | | | | | |
|------|-----|------|----|-----|-----|------|----|----|------|
| S5-P | 32' | 2 T8 | SC | 91W | 277 | AC18 | FE | C1 | 0.88 |
|------|-----|------|----|-----|-----|------|----|----|------|

Finelite **Series 5 (P-Perforated, I-Indirect)** _____
Run length **32'** (8' multiples standard) _____
Number of lamps in cross section **2, 3 T8** (1, 2, 3 T5, T5HO) _____
Circuiting (SC-single circuit, **DC-dual circuit**) _____
Reflector system **91W** EP, SPEC) _____
Voltage (120, **277**, 347V) _____
Mounting **AC** FA, Stem) _____
Endcap FE (flat), RE (rounded), **XE (recessed)** _____
Ceiling type (C1-1" T-bar, C2-9/16" T-bar, C3-Slot Grid, C4-Hard Ceiling) _____
Ballast factor **Standard 0.88 for T8 lamps**, 1.0 for T5 or T5HO) _____



FINELITE

Series 5 - Technical Sheet

PHOTOMETRY



S5-P: 1 T5HO - EP
Distribution: 98% Up / 2% Down
Efficiency: 77.1%
Peak Candela Value: 1147@ 115°
LSI Report 52368

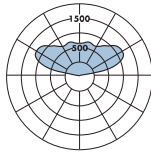

S5-P: 2 T8 - EP
Distribution: 92% Up / 8% Down
Efficiency: 78.6%
Peak Candela Value: 1072@ 180°
LSI Report 50255

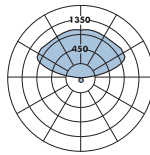

S5-P: 3 T8 - EP
Distribution: 94% Up / 6% Down
Efficiency: 82.0%
Peak Candela Value: 1906@ 135°
LSI Report 46916

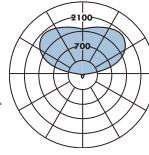

| CANDLEPOWER SUMMARY | | | | | | |
|---------------------|-----|------|------|------|------|------|
| | 0.0 | 22.5 | 45.0 | 67.5 | 90.0 | Flux |
| 0 | 22 | 22 | 22 | 22 | 22 | |
| 5 | 22 | 22 | 22 | 21 | 20 | 2 |
| 15 | 21 | 21 | 23 | 24 | 23 | 6 |
| 25 | 18 | 20 | 21 | 22 | 21 | 9 |
| 35 | 14 | 17 | 18 | 19 | 18 | 11 |
| 45 | 10 | 13 | 14 | 16 | 16 | 11 |
| 55 | 7 | 10 | 11 | 14 | 14 | 10 |
| 65 | 4 | 6 | 8 | 11 | 11 | 8 |
| 75 | 1 | 3 | 5 | 7 | 7 | 5 |
| 85 | 0 | 2 | 3 | 4 | 4 | 3 |
| 90 | 0 | 1 | 2 | 2 | 3 | |
| 95 | 30 | 172 | 111 | 83 | 44 | 131 |
| 105 | 142 | 412 | 717 | 780 | 765 | 604 |
| 115 | 271 | 458 | 806 | 1062 | 1147 | 747 |
| 125 | 396 | 482 | 771 | 990 | 1108 | 672 |
| 135 | 508 | 566 | 732 | 904 | 978 | 570 |
| 145 | 601 | 652 | 687 | 791 | 852 | 449 |
| 155 | 674 | 698 | 732 | 739 | 752 | 334 |
| 165 | 721 | 728 | 747 | 762 | 769 | 211 |
| 175 | 745 | 745 | 745 | 742 | 744 | 71 |
| 180 | 743 | 743 | 743 | 743 | 743 | |

| CANDLEPOWER SUMMARY | | | | | | |
|---------------------|------|------|------|------|------|------|
| | 0.0 | 22.5 | 45.0 | 67.5 | 90.0 | Flux |
| 0 | 149 | 149 | 149 | 149 | 149 | |
| 5 | 149 | 149 | 148 | 148 | 146 | 14 |
| 15 | 139 | 140 | 142 | 145 | 144 | 40 |
| 25 | 121 | 125 | 128 | 132 | 130 | 59 |
| 35 | 98 | 104 | 107 | 113 | 112 | 67 |
| 45 | 70 | 78 | 84 | 93 | 94 | 65 |
| 55 | 43 | 53 | 64 | 76 | 78 | 57 |
| 65 | 23 | 31 | 44 | 58 | 61 | 43 |
| 75 | 10 | 16 | 27 | 40 | 43 | 29 |
| 85 | 1 | 8 | 14 | 23 | 26 | 16 |
| 90 | 0 | 8 | 15 | 13 | 23 | |
| 95 | 37 | 163 | 200 | 239 | 222 | 202 |
| 105 | 211 | 376 | 599 | 650 | 635 | 538 |
| 115 | 393 | 481 | 746 | 931 | 995 | 704 |
| 125 | 572 | 619 | 780 | 957 | 1030 | 708 |
| 135 | 731 | 769 | 837 | 948 | 994 | 661 |
| 145 | 864 | 885 | 914 | 962 | 988 | 579 |
| 155 | 969 | 979 | 999 | 1016 | 1015 | 460 |
| 165 | 1038 | 1043 | 1043 | 1049 | 1052 | 296 |
| 175 | 1075 | 1074 | 1069 | 1066 | 1066 | 102 |
| 180 | 1072 | 1072 | 1072 | 1072 | 1072 | |

| CANDLEPOWER SUMMARY | | | | | | |
|---------------------|------|------|------|------|------|------|
| | 0.0 | 22.5 | 45.0 | 67.5 | 90.0 | Flux |
| 0 | 182 | 182 | 182 | 182 | 182 | |
| 5 | 182 | 183 | 182 | 181 | 178 | 17 |
| 15 | 170 | 173 | 176 | 180 | 178 | 50 |
| 25 | 148 | 155 | 159 | 165 | 162 | 73 |
| 35 | 120 | 131 | 134 | 143 | 140 | 84 |
| 45 | 86 | 99 | 104 | 117 | 116 | 81 |
| 55 | 53 | 68 | 78 | 93 | 93 | 70 |
| 65 | 28 | 40 | 52 | 69 | 71 | 52 |
| 75 | 12 | 21 | 31 | 47 | 48 | 34 |
| 85 | 2 | 11 | 17 | 27 | 28 | 19 |
| 90 | 1 | 7 | 19 | 17 | 29 | |
| 95 | 42 | 197 | 200 | 242 | 210 | 213 |
| 105 | 299 | 625 | 758 | 824 | 797 | 724 |
| 115 | 605 | 900 | 1261 | 1378 | 1387 | 1118 |
| 125 | 887 | 1139 | 1487 | 1728 | 1794 | 1272 |
| 135 | 1148 | 1343 | 1607 | 1824 | 1906 | 1217 |
| 145 | 1361 | 1495 | 1680 | 1838 | 1903 | 1042 |
| 155 | 1531 | 1603 | 1720 | 1810 | 1850 | 789 |
| 165 | 1640 | 1665 | 1716 | 1751 | 1776 | 485 |
| 175 | 1687 | 1682 | 1687 | 1682 | 1690 | 161 |
| 180 | 1675 | 1675 | 1675 | 1675 | 1675 | |

— Refer to www.finelite.com for additional photometry and product information.

SPECIFICATIONS

CONSTRUCTION: Body is 20-gauge die-formed steel with 18-gauge die-formed internal joiner system, plug-together wiring standard. All components are hard-tooled to tolerances of 0.010".

Precision-punched 0.062" diameter perforations cover the bottom side of the fixture in two parallel columns.

ENDCAPS: Flat Endcap (FE) standard, 18-gauge die-formed steel endcaps, adds 0.1" at each end.

Optional: Recessed Endcap (XE), die-cast aluminum Recessed Endcap with 1/8" reveal. Recessed endcap adds 1.5" each end.

Optional: Rounded Endcap (RE), injection molded sculpted endcap with 1/8" reveal. No exposed fasteners, holes or knockouts. Rounded Endcap adds 5.675" at each end.

REFLECTORS: Die-formed prepainted aluminum, 91% reflective white. Virgin acrylic UV-stabilized lens diffuser over perforations is standard. Options: Extended

performance reflector (EP) with 95% reflective specular components; fully specular reflector system (SPEC) with specular slotted side reflectors. Optional Dust Cover for T8 lamps only. Contact factory.

SUPPORT CABLES: Plated steel cable and hardware.

MOUNTING OPTIONS: Semi-adjustable aircraft cable ($\pm 0.5"$) in lengths of 12", 15", 18", 21", 24", 27", 30", and 36". Optional Adders: fully adjustable aircraft cable in lengths up to 150". Rigid stems.

FINISHES: Signal White standard. Optional Adders: 185 colors available from Tiger Drylac's RAL color chart.

LAMPING: Available in 2-or 3-lamp cross sections with T8, T5, and T5HO lamps.

FEED: 18-gauge straight cord. 14-gauge feed cord used when fixture current exceeds 6 amps. Optional Adders: Coil Cord Feed, Rigid Stem Feed.

ELECTRICAL: 120 or 277V prewired. Plug-together wiring standard. Fixture and electrical components are UL and C-UL listed and fixture will bear UL and C-UL labels. Optional Adders: dual circuit, emergency circuits, low-profile emergency battery packs. Contact factory.

BALLAST: Electronic instant-start ballast <10% THD, 0.88 BF standard for T8 lamps. Electronic rapid-start ballasts <10% THD, 1.0 BF standard for T5/T5HO lamps. Optional adders: rapid-start ballasts (standard for T5/T5HO), 347V, emergency battery packs, dimming ballasts (controls by others). Requires low-profile ballasts and battery packs.

LENGTHS: 4' and 8' section lengths can be combined to make longer runs. Contact factory for additional lengths.

WEIGHT: Fixture weight = 2.5 lb/ft.



FEATURES & SPECIFICATIONS

INTENDED USE — The Avante 2x4 is a general lighting luminaire for large spaces including open offices, circulation areas, classrooms, libraries, cafeterias, airport ticketing and wait areas, and numerous other commercial applications. Static or air functions available. **Certain airborne contaminants can diminish integrity of acrylic.** [Click here for Acrylic Environmental Compatibility table for suitable uses.](#)

CONSTRUCTION — Housing is gloss white enamel on cold rolled steel. All edges hemmed or rounded.

All shieldings pivot on light traps and swing down for easy lamp access.

Molded light traps prevent light leaks between shielding and endplates.

All air and screw slot units supplied with screw-on tee bar clips. Ballast access is from below.

OPTICS — Twin matte white polyester powder paint finished reflectors provide uniform light distribution. Optional low brightness diffuse aluminum stepped reflectors available.

All diffusers control direct light distribution and glare by shielding lamps from direct view. Metal diffuser staggered round holes (MDR) 52% open perforated metal with .075" diameter holes backed with white acrylic diffuser.

Straight blade louver (SBL) sides of perforated metal with staggered round holes and solid blade louvered center. Sides and louver backed with white acrylic diffuser. Metal diffuser aligned mini slots (MDM) 46% open perforated metal backed with white acrylic diffuser.

Acrylic diffuser prismatic lens (ADP) extruded acrylic lens backed with white acrylic diffuser.

Metal diffuser with center slots (MDC). 52% open metal, .075" diameter holes with 1" wide solid center. Slotted with 1/2"x2" open slots. Diffuser is backed with white acrylic overlay.

ELECTRICAL — All ballasts supplied are class P, thermally protected, resetting, HPF, non-PCB, UL Listed, CSA Certified. Ballasts are sound rated A. Standard combinations conform to UL 935.

INSTALLATION — Trims available for standard 1" and 9/16" tee bar or screw slot grids. Fixtures can be row mounted end-to-end.

Drywall ceiling adapters available.

LISTINGS — UL Listed to US and Canadian safety standards. Chicago Plenum approved and NYC approved (see Options).

Avante is covered by one or more of the following patents: 5,988,829; 399,586; 411,641; 413,402; 2,212,513; 87,513.

WARRANTY — 1-year limited warranty. Complete warranty terms located at www.acuitybrands.com/CustomerResources/Terms_and_conditions.aspx

NOTE: Specifications are subject to change without notice.

| | |
|----------------|----------------|
| Catalog Number | |
| Notes | Type FC/FCE |

Avante[®]
Direct/Indirect Lighting

2AV 2'x4'

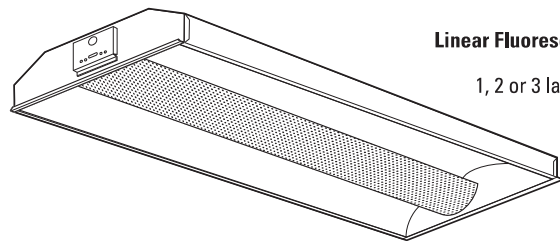

**Linear Fluorescent
T8**
1, 2 or 3 lamps

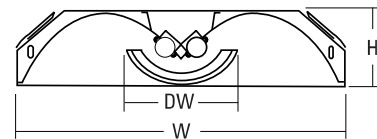

Specifications

Length: 48 (121.9)

Width: 24 (61.0)

Diffuser width: 8 (20.3)

Depth: 5-1/2 (14.0)

5-7/8 (14.9) for air fixture

All dimensions are inches (centimeters) unless otherwise indicated.

ORDERING INFORMATION

For shortest lead times, configure product using **standard options (shown in bold)**.

Example: 2AV G 2 32 MDR MVOLT GEB10IS

| 2AV | G | 3 | 32 | MDR | 120 | 1/3 GEB LP735 |
|---------------|---|----------------------------------|-----------------|--|--|---|
| Series | | Number of lamps | Lamp type | | Voltage | Options |
| 2AV 2' wide | | 1 2 3 Not included. | 32 32W T8 (48") | | MVOLT ² 347 Others available. | GEB10IS Electronic ballast, ≤ 10% THD, instant start |
| Trim type | | | | | | GEB10RS Electronic ballast, ≤ 10% THD, rapid start |
| G Grid trim | | | | | | S5100 1.0 ballast factor, SIMPLY5™ system ⁴ |
| ST Screw slot | | | | | | ALG Acrylic litter guard ¹ |
| | | Air function | | Diffuser | | EL14 Emergency battery pack (nominal 1400 lumens, see Life Safety section) |
| | | (blank) Static (no air function) | | MDR Metal diffuser, round holes | | GLR Internal fast-blow fuse ³ |
| | | A Air return/supply | | SBL Straight blade louver, round holes | | HW Hardwire for SIMPLY5™ system; replaces RELOC® wiring |
| | | | | MDM Metal diffuser, mini slots | | PWS1836 6' prewire, 3/8" dia., 18-gauge, 3 wires |
| | | | | ADP Acrylic diffuser, linear prismatic lens | | NY3 New York City approved |
| | | | | MDC Metal diffuser, round holes with large center slots ¹ | | CP Chicago Plenum approved |
| | | | | Others available. | | APB Air pattern control blades ¹ |
| | | | | | | <u>Reflector option</u> |
| | | | | | | ASR Aluminum stepped reflector |

NOTES:

1 Refer to options and accessories section for more detailed information.

2 MVOLT (120 - 277 volt).

3 Must specify voltage, 120 or 277.

4 SIMPLY5 system includes 13' S5SSC RELOC wiring system. Specify voltage unless HW (hardwire) or PWS1836 is ordered.

Fluorescent

Sheet #: 2AV 2X4 T8

ARCH-280

**PROVIDE TWO BALLASTS FOR DUAL LEVEL
SWITCHING WHERE INDICATED ON PLAN**

**PROVIDE EMERGENCY BATTERY BALLAST
FOR FIXTURES DESIGNATED WITH AN "E" SUFFIX**

2AV 2x4 Direct/Indirect Lighting

2AV G 2 32 MDR, (2) 32W T8 lamps, 2850 lumens per lamp, s/m 1.2 (along) 1.3 (across), test no. LTL 10121

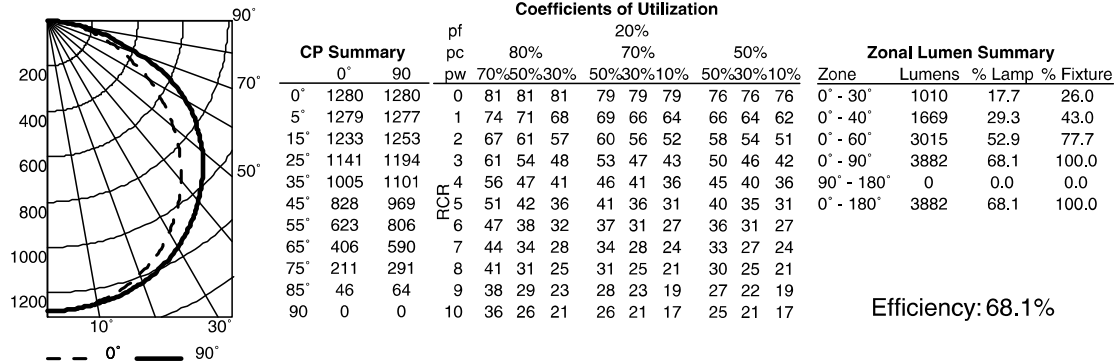

2AV G 3 32 MDR, (3) 32W T8 lamps, 2850 lumens per lamp, s/m 1.3 (along) 1.3 (across), test no. LTL 10155

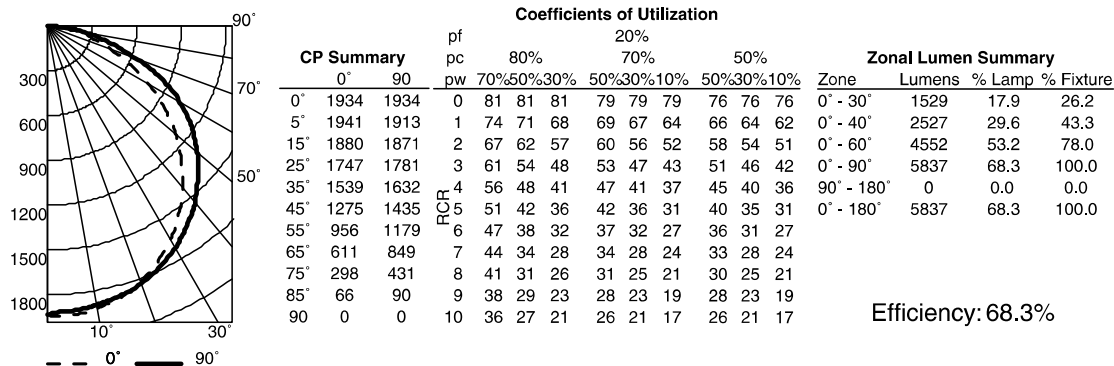

2AV G 3 32 MDR ASR, (3) 32W T8 lamps, 2850 lumens per lamp, s/m 1.2 (along) 1.3 (across), test no. LTL 10120

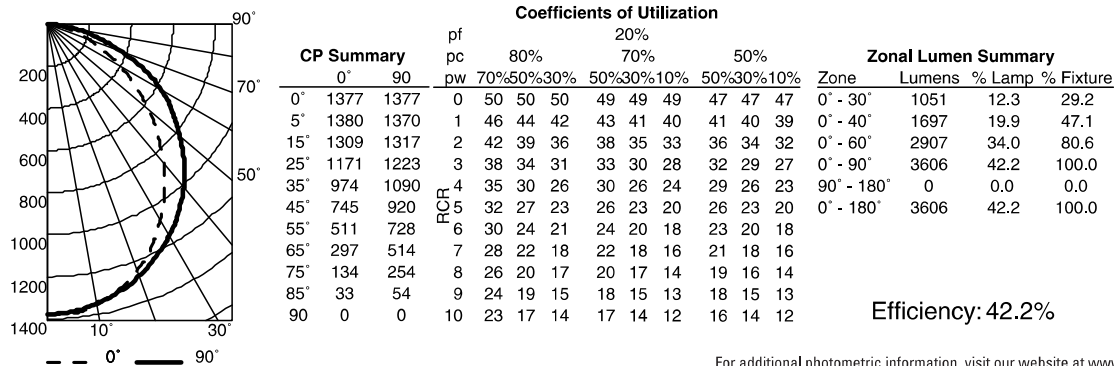

For additional photometric information, visit our website at www.lithonia.com.

MOUNTING DATA

| Ceiling Type | Appropriate Trim Type |
|---------------------------------|-----------------------|
| Exposed grid tee (1' and 9/16") | G |
| Concealed grid tee | G |
| Screw slot | ST |
| Plaster or plasterboard | G* |

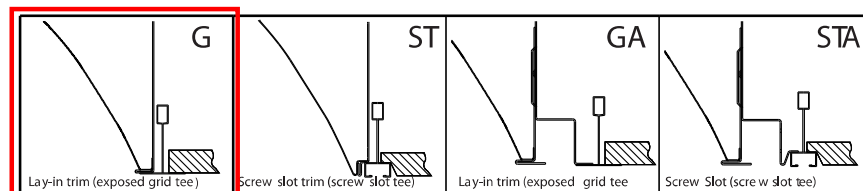

*DGA accessory available to provide ceiling trim flange and fixture support for plaster or plasterboard ceiling. Recommended rough-in dimensions for DGA installation is 24-3/4" x 48-3/4" (Tolerance is +1/8", -0").



Lithonia Lighting
Fluorescent
One Lithonia Way, Conyers, GA 30012
Phone: 800-858-7763 Fax: 770-929-8789
www.lithonia.com

Sheet #: 2AV 2X4 T8

© 2007-2012 Acuity Brands Lighting, Inc. All rights reserved. Rev. 03/21/12